

# QT-2100

## Versatile Intelligent Terminal

# Programming Manual

Version 1.0 February 2002

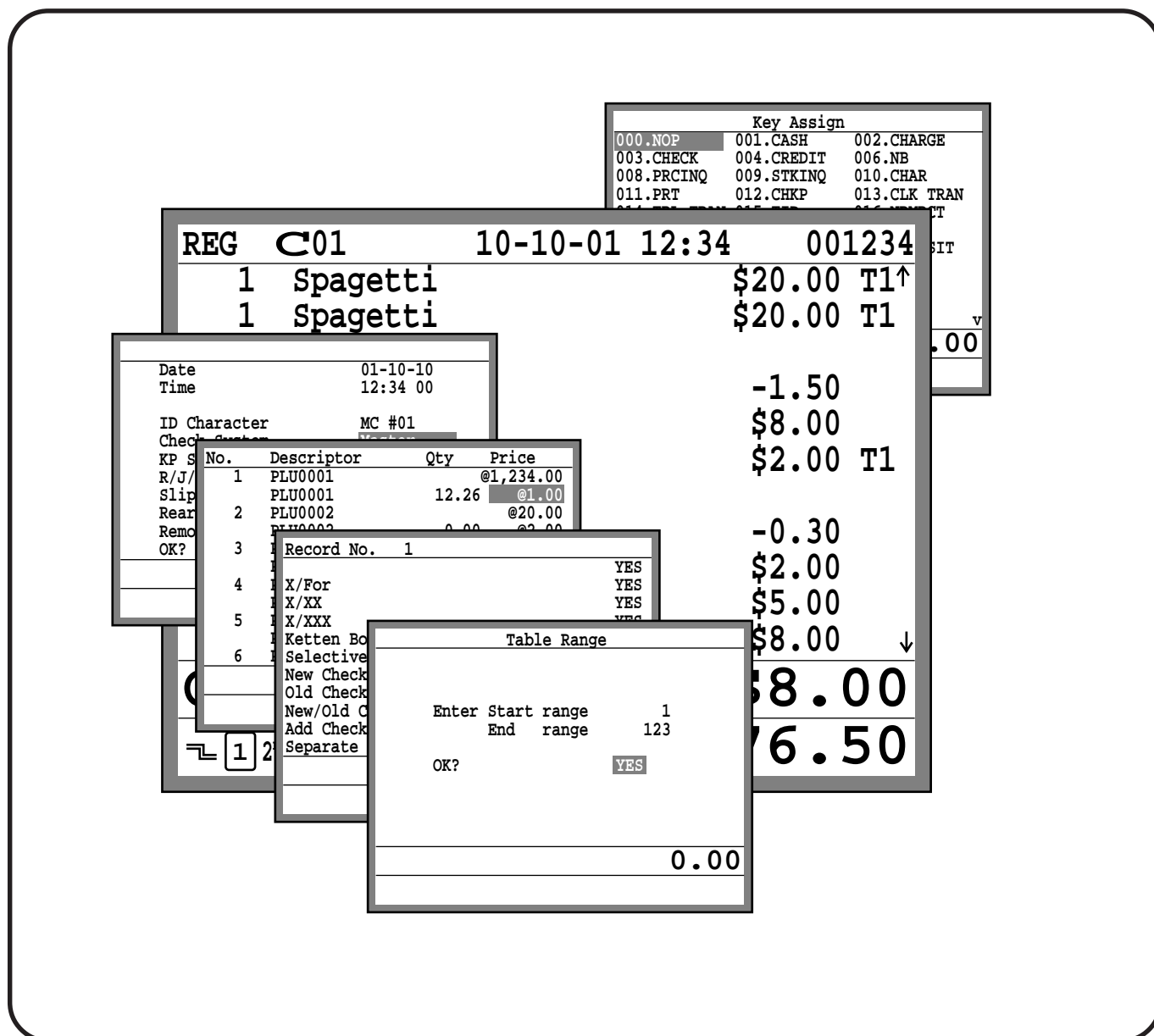

<b>1. Machine Initialization .....</b>	<b>P-8</b>
1-1. How to initialize QT-2100 terminal .....	P-8
1-2. How to initialize QT-2100 terminal (add/replace one QT-2100) .....	P-11
1-3. How to flag clear QT-2100 terminal (or INIT2) .....	P-14
<b>2. Program 5 .....</b>	<b>P-16</b>
2-1. Programming memory allocation (daily & program) .....	P-16
2-2. Programming memory allocation (periodic & work) .....	P-17
2-3. Programming memory allocation file by file .....	P-18
<b>3. Program 4 .....</b>	<b>P-24</b>
3-1. Programming key allocation.....	P-24
3-2. Programming key allocation (key location change) .....	P-26
3-3. Programming key allocation.....	P-28
<b>4. Program 3 .....</b>	<b>P-34</b>
4-1. Programming machine features .....	P-34
4-1-1 Programming pulldown group (adding/modifying/deleting group item) .....	P-34
4-1-2 Programming set menu table .....	P-36
4-1-3 Programming arrangement .....	P-38
4-1-4 Programming batch X/Z report .....	P-39
4-1-5 Programming the general feature .....	P-41
4-1-6 Programming scheduler .....	P-58
4-1-7 Programming check print .....	P-60
4-1-8 Programming table analysis .....	P-61
4-1-9 Programming tax table .....	P-62
4-1-10 Programming void table .....	P-65
4-1-11 Programming system connection .....	P-66
4-1-12 Programming I/O parameter .....	P-67
4-1-13 Programming printer connection .....	P-70
4-1-14 Programming time zone .....	P-71
4-1-15 Programming time & attendance .....	P-72
4-1-16 Programming hourly item link .....	P-76
4-1-17 Programming IDC link .....	P-77
4-1-18 Programming Euro .....	P-78
4-1-19 Programming auto program control .....	P-79
4-2. Programming clerks .....	P-80
4-2-1 Programming clerk features .....	P-80
4-2-2 Programming operation .....	P-82
4-2-3 Programming commission rate.....	P-92
4-2-4 Programming table range .....	P-93
4-2-5 Programming clerk by range .....	P-94
4-2-6 Programming clerk detail.....	P-106
4-2-7 Programming clerk key ID .....	P-107

4-3. Programming key features .....	P-108
4-3-1 Programming PLU features .....	P-108
4-3-2 Programming PLU 2nd@ features .....	P-110
4-3-3 Programming subdepartment features .....	P-111
4-3-4 Programming department features .....	P-112
4-3-5 Programming by range .....	P-113
4-3-6 Programming individual program .....	P-116
4-3-7 Programming key function program .....	P-117
4-3-8 Programming shift PLU program .....	P-135
4-3-9 Programming scanning PLU link program .....	P-136
<b>5. Program 2 .....</b>	<b>P-140</b>
5-1. Character programming .....	P-140
5-1-1 Character programming keyboard .....	P-140
5-1-2 Inputting characters by code .....	P-142
5-1-3 After completing to input characters .....	P-142
5-2. Programming item descriptors .....	P-143
5-2-1 Programming PLU item descriptors .....	P-143
5-2-2 Programming PLU 2nd unit price descriptors .....	P-144
5-2-3 Programming subdepartment descriptors .....	P-144
5-2-4 Programming department descriptors .....	P-145
5-2-5 Programming PLU/subdepartment/department descriptors by range .....	P-146
5-2-6 Copying PLU descriptors to PLU 2nd unit price .....	P-147
5-2-7 Programming function key descriptors .....	P-148
5-3. Programming characters and messages .....	P-149
5-3-1 Programming receipt message, slip message and guest receipt message .....	P-149
5-3-2 Programming text recall message .....	P-150
5-3-3 Programming order character link .....	P-150
5-3-4 Programming fixed totalizer descriptors .....	P-151
5-3-5 Programming group character .....	P-152
5-3-6 Programming special characters .....	P-152
5-3-7 Programming report headers .....	P-154
5-3-8 Programming endorsement message .....	P-155
5-3-9 Programming GT character .....	P-155
<b>6. Program 1 .....</b>	<b>P-158</b>
6-1. Presetting date and time .....	P-158
6-2. Programming unit price and rate .....	P-159
6-2-1 Programming PLU unit price .....	P-159
6-2-2 Programming PLU 2nd unit price .....	P-160
6-2-3 Programming PLU unit price and PLU 2nd unit price .....	P-161
6-2-4 Programming subdepartment unit price .....	P-162
6-2-5 Programming department unit price .....	P-162
6-2-6 Programming PLU/PLU 2nd@/subdepartment/ department unit price by range .....	P-163
6-2-7 Copying PLU unit price to PLU 2nd unit price .....	P-165
6-2-8 Programming amount or rate to keys .....	P-166
6-2-9 Programming unit price of shift PLU .....	P-167

<b>7. Program 6 .....</b>	<b>P-170</b>
7-1. Program read general procedure .....	P-170
7-2. Program read report sample .....	P-171
7-2-1 Unit Price/Qty .....	P-171
7-2-2 Item Descriptor .....	P-172
7-2-3 Character and Message .....	P-172
7-2-4 Machine feature .....	P-176
7-2-5 Clerk .....	P-208
7-2-6 Key feature .....	P-220
7-2-7 Keyboard .....	P-242
7-2-8 Memory allocation .....	P-242
<b>Index .....</b>	<b>P-244</b>
Program 3 mode Hierarchy .....	P-247
Program 1 mode Hierarchy .....	P-248
Program 2 mode Hierarchy .....	P-248
Program 6 mode Hierarchy .....	P-248

This is a “Table of Contents preview” for quality assurance

The full manual can be purchased from our store:

[https://the-checkout-tech.com/manuals/casio/QT-2100 programming manual.html](https://the-checkout-tech.com/manuals/casio/QT-2100_programming_manual.html)

And our free Online Keysheet maker:

<https://the-checkout-tech.com/Cash-Register-Keysheet-Creator/>

[HTTPS://THE-CHECKOUT-TECH.COM](https://THE-CHECKOUT-TECH.COM)